

SHOULDER PAD REMOVAL:

12 Turn Carrier over (upside down).

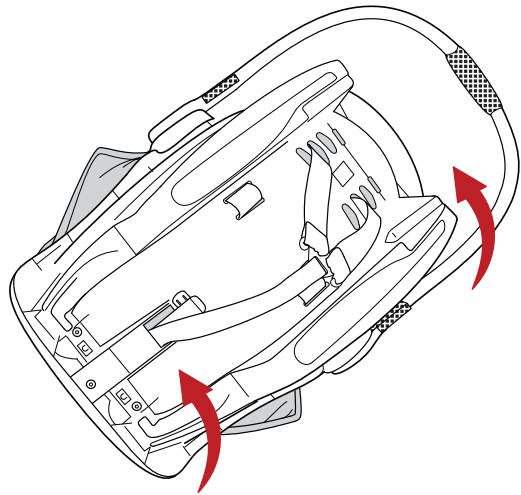

13 Remove Right and Left Harness Straps from the Splitter plate.

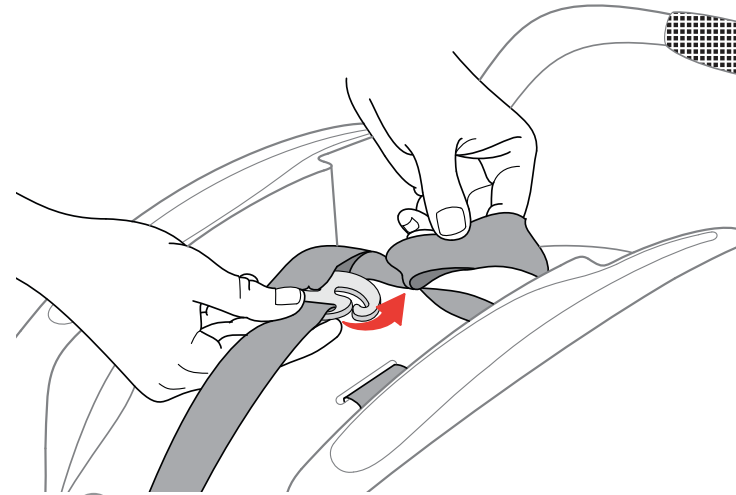
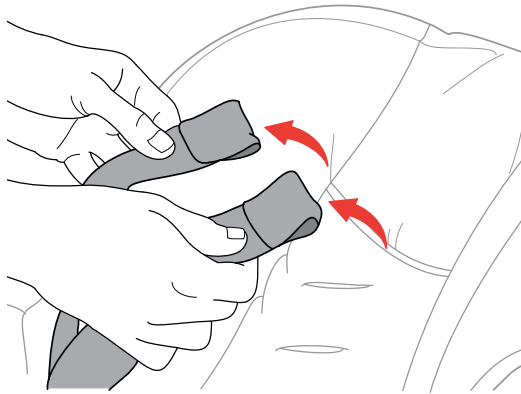

14 Turn Carrier back over and pull the Harness Straps from the Carrier.

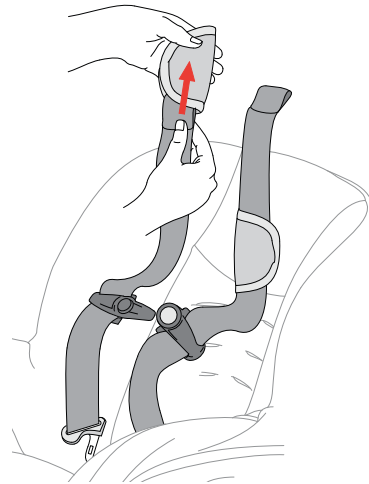

15 Remove both Shoulder Pads from Harness Straps. Refer to Adjusting Harness Height in the User Guide to ensure proper reassembly of Harness Straps.

⚠ WARNING: Avoid serious injury or death to your child. You must make sure that all harness components have been replaced correctly, so the seat can provide maximum crash protection. Pull on adjuster strap and the shoulder straps of the harness and operate the harness after this replacement is complete. Make sure all straps are properly routed and secured. Make sure Chest Clip, and Buckle Tongues are oriented and installed correctly. If you have a problem, retry these instructions provided AND review your User Guide. If you still have problems, STOP, Do Not use the Car Seat, and call Chicco at 1-877-424-4226.

⚠ CAUTION

These instructions are in addition to the instructions in the User Guide. Only the differences in the canopy, seat pad, and boot are outlined. To avoid serious injury or death to your child, you must read and understand these instructions and the User Guide.



⚠ WARNING: Avoid serious injury or death to your child. Never use your KeyFit car seat without seat padding in place. You must read and understand the KeyFit 30 Zip Features and Softgoods Removal instructions **AND** the instructions in the User Guide. Keep these instructions. Fold instructions and store with the booklet in the KeyFit Base. If you do not understand these instructions, **DO NOT** attempt to remove the Softgoods, **STOP** and call Chicco at 1-877-424-4226.

INSTRUCTIONS: KeyFit® 30 Zip Features and Softgoods Removal

IMPORTANT: Please also refer to the instructions that came with your product.

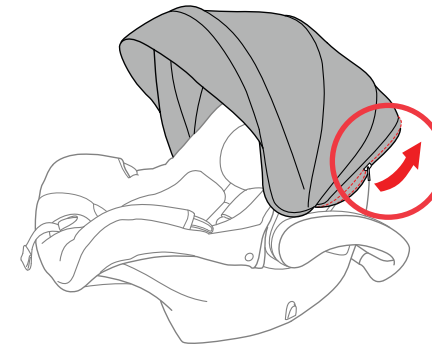
EXTENDING CANOPY:

1 To extend the Canopy unzip the zipper located at the back of the Canopy (as shown).

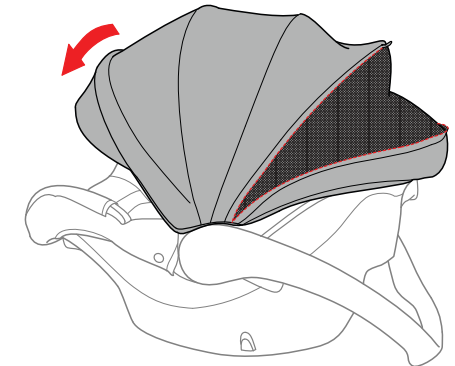

2 Once unzipped, pull the Canopy forward. This will extend the mesh section of the Canopy and shield more of the child in the KeyFit.

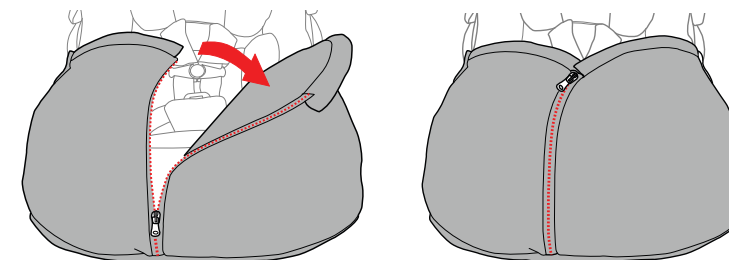
OPENING BOOT:

3 Once the Boot is secured, you can still access the baby through the front zippered flap.

SOFTGOODS REMOVAL:

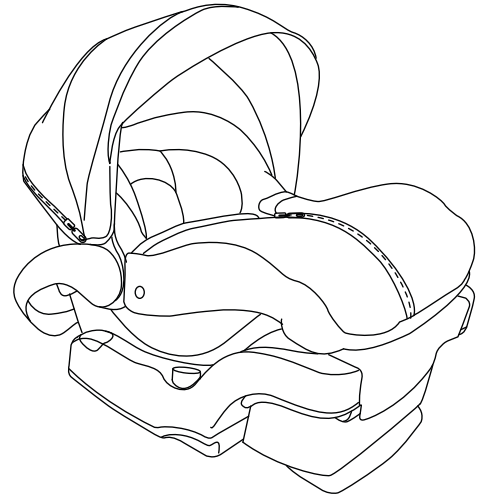

PARTS LIST:

- A. Newborn Positioner
- B. Headrest Insert
- C. Shoulder Pads
- D. Crotch Strap Pad
- E. Boot

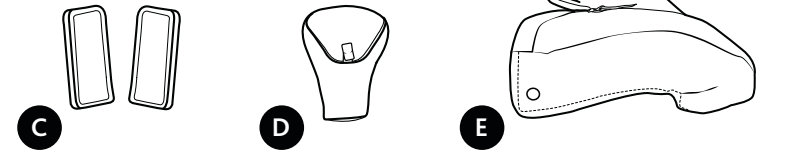

TO REMOVE THE SEAT PAD:

Completely loosen the harness straps. Remove the Boot (See Steps 4-5). Remove the Crotch Strap Pad (See Step 6). Refer to User Guide to remove the Canopy, Headrest Insert and Newborn Positioner (See Step 7). Remove the Seat Pad (See Steps 8-11).

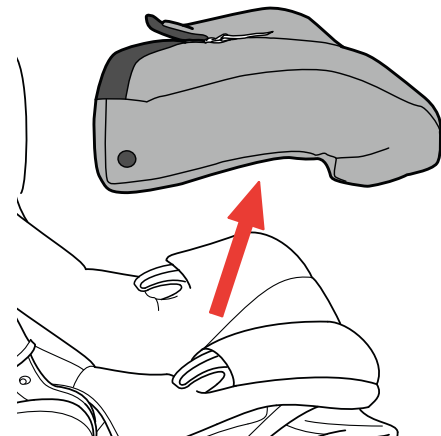
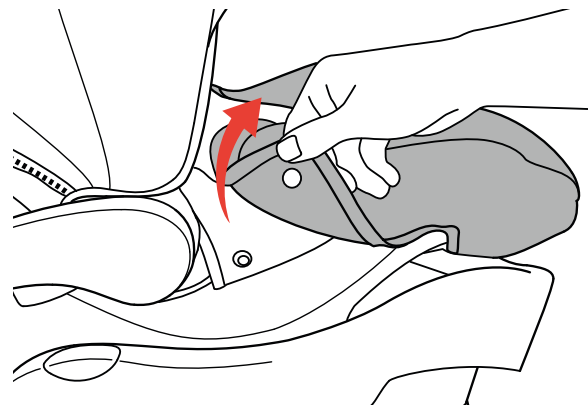

4 BOOT: To remove, undo the snap button located on the side of Boot. Repeat for other side.

5 Remove the boot. Guide the section from under the front edge of the seat and lift up and remove the boot.

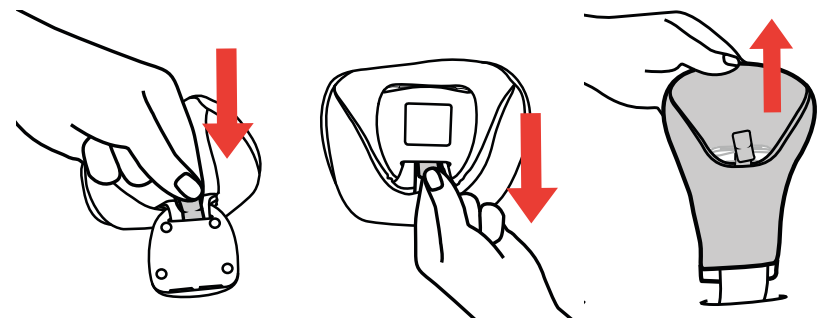

IMPORTANT! If the Crotch Strap Pad prevents the harness from properly fitting a small Infant, remove immediately and store for future use.

6 CROTCH STRAP PAD: Unbuckle the Harness and remove Crotch Strap Pad by locating the Tab and pushing it through the Harness Buckle. Pull the Tab out through the front of the Harness Buckle and remove.

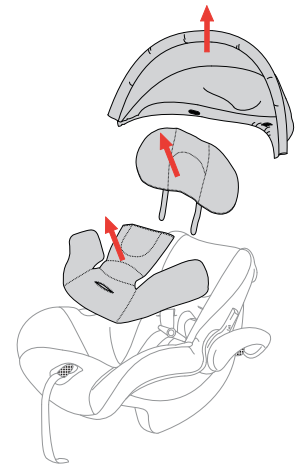

7 Refer to user guide to remove the Canopy, Headrest Insert and Newborn Positioner.

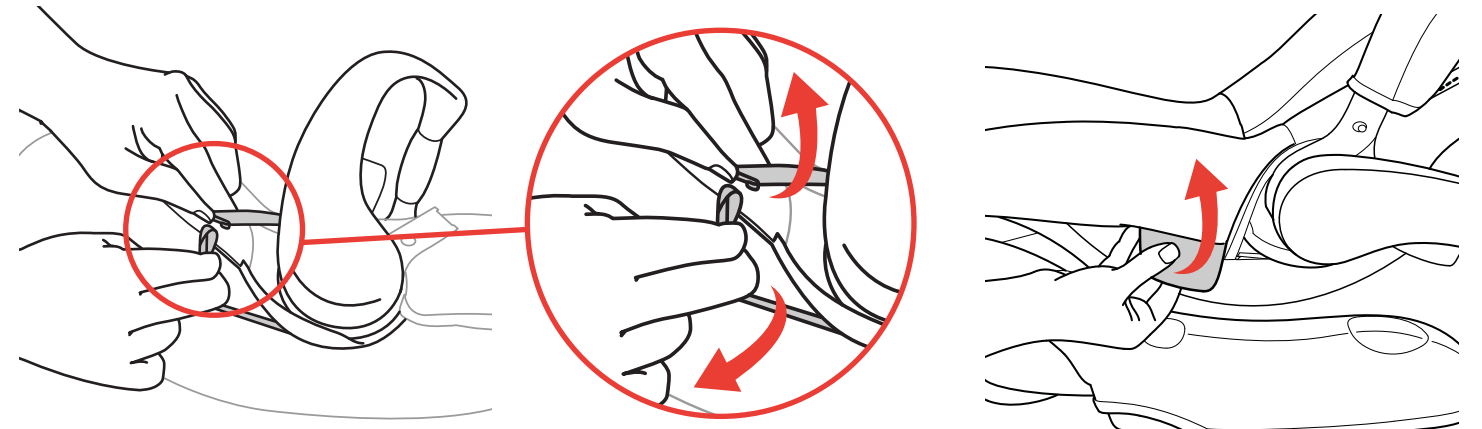

8a Unhook the elastic band attached around handle pivot, repeat for the other side.

8b Pull out plastic tabs located on both sides of the seat pad.

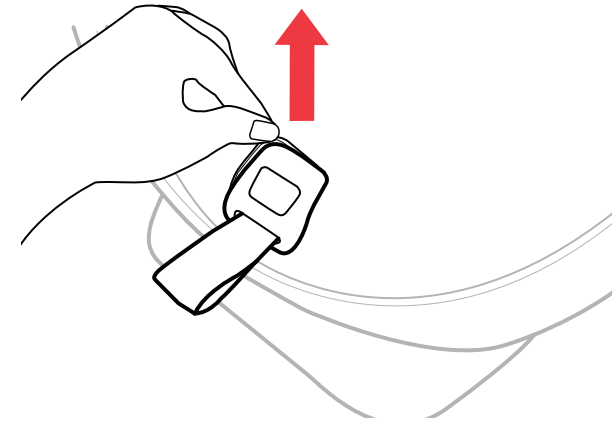

9 Pull Seat Pad away from the Adjuster Cover as shown.
Hint: To help remove the Seat Pad, pinch the fabric above the Adjuster Cover and pull forward.

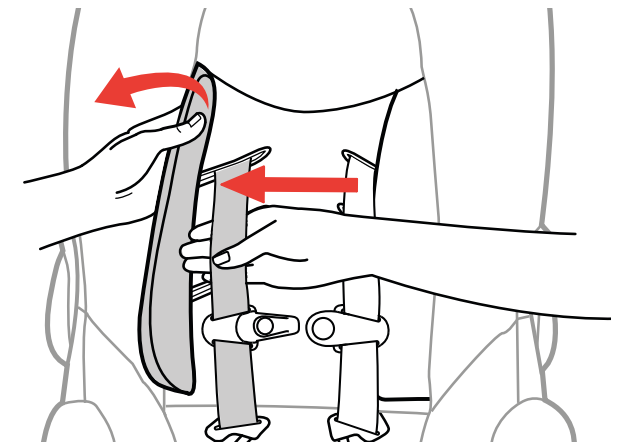

10 Pull the side of the Seat Pad up and slide the Harness Strap behind the Seat Pad at the shoulder and the waist, repeat for the other Harness Strap.

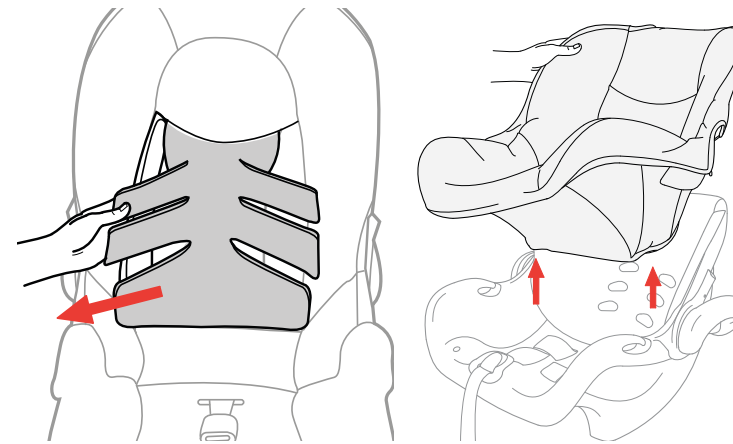

11 Make sure the Harness Straps are completely tucked behind the back of the Seat Pad and remove the Seat Pad.
Make sure back piece of the Seat Pad is properly tucked into the softgoods when re-attaching the Seat Pad.

12 To reinstall softgoods, follow steps 4-11 in reverse.

IMPORTANT! Make sure all softgoods are properly installed before use.

CLEANING INSTRUCTIONS:

Fabrics may be spot-cleaned with mild soap and water, or machine washed in cold water on delicate cycle using mild detergent. Hang to dry. **DO NOT BLEACH.**

Please consult your product manual for instructions on additional care and maintenance instructions.